

## Eye nut RM - M48X3

Artikel-Nr: 7995961



For the RUD RM - eye nuts, the threaded connector component must be of at least quality grade 8.8

- Considerably higher WLL (in comparison to DIN 582) at vertical load.
- Large thread and WLL range (M6-M48, 0.1 t – 8 t).
- Clear marking of the minimum WLL for all loading directions.
- Quick and easy installation with just one bolt connection.

Other important RUD specific information and specialities to our RUD lifting points can be found in the specific user instruction.

## Eye nut RM - M48X3

Artikel-Nr: 7995961

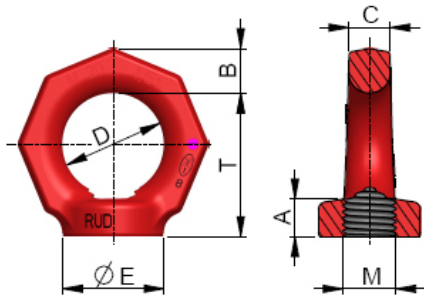

<b>weight</b>	5.30 kg	11.68 lbs
<b>Nominal WLL</b>	8000 kg	17600 lbs
<b>T</b>	130 mm	5-1/8"
<b>A</b>	37 mm	1-7/16"
<b>B</b>	43 mm	1-11/16"
<b>C</b>	38 mm	1-1/2"
<b>D</b>	90 mm	3-17/32"
<b>E</b>	100 mm	3-15/16"
<b>M</b>	M48X3 mm	M48X3